

1. Type
 Single Family

2. Frame
 Wood

3. Exterior
 Siding: Wood
 Aluminum
 Brick
 Block

4. Roof
 Hip
 Gable
 Front Overhang
 Other Overhang
 Eavestrough

5. Windows
 Many
 Large
 Wood Sash
 Metal Sash
 Mergl Sash
 Double Hung
 Hor. Sliding
 Double Glass
 Complete Trim
 No Inside Trim
 Storms & Scr.

6. Year Built:
 1966

7. Year Remod.

8. Number Rooms
 Basement
 1st Floor
 2nd Floor
 Bath

9. Insulation
 Ceiling
 Exterior
 None

10. Floor Support
 Joists "x" " " " o.c.
 Unsupported Length ft.
 Sill Piers: Yes No
 Diag. Sub-Floor "x" " "
 Ply. Sub-Floor "x" " "
 Center Support \$680

11. Basement & Foundation
 Craw Space
 Slab House
 Basement Full s.f.
 Height to Joists ft.
 Concrete Block
 Concrete Walls
 Concrete Floor
 Asphalt Tile s.f.
 Recreation Room s.f.

12. Heating & Air Conditioning
 Gas - Forced Warm Air
 Oil - Forced Warm Air
 Gas Oil Coal
 Wall Fur. Floor Fur.
 Stone or Space Heat
 Storm Radiators
 Forced Warm Water
 AIR CONDITIONER tons
 FIREPLACE ft.

13. Interior
 Trim & Decorations:
 Etlsh. Ord. Min.
 Size of Closets:
 Large Ord. Small
 Number of Closets:
 Many Ord. Few

14. Plumbing
 No. of Baths
 Cer. Tile Walls
 Cer. Tile Floor
 Plastic Tile Walls
 Extra Sool
 Extra Wash Bowl
 Water Heater:
 Gas Gas Elec.

15. Built-in Items
 Oven Range \$
 Disposal
 Hood & Fan
 Dishwasher
 Refrigerator
 Incinerator
 Vanities
 Cupboard Length
 Cupboard Quality

16. Garage
 Year Built 2014
 Attached Separate
 Car Condition
 Wide Deep
 Walls 5' x 8' studs
 Floor 2" x 4" boards
 Doors 200
 Common Wall
 Other Walls
 Ceiling
 CLASS CD Size for Rates 950
 Typical Classes of Other Houses
 In this Neighborhood Improving Stable
 Declining
 Condition for Age
 Effective Age

17. Porches
 Wide Deep Type
 5' 4' 000
 Priced by HDU
 Date 9-3-74
 Checked by

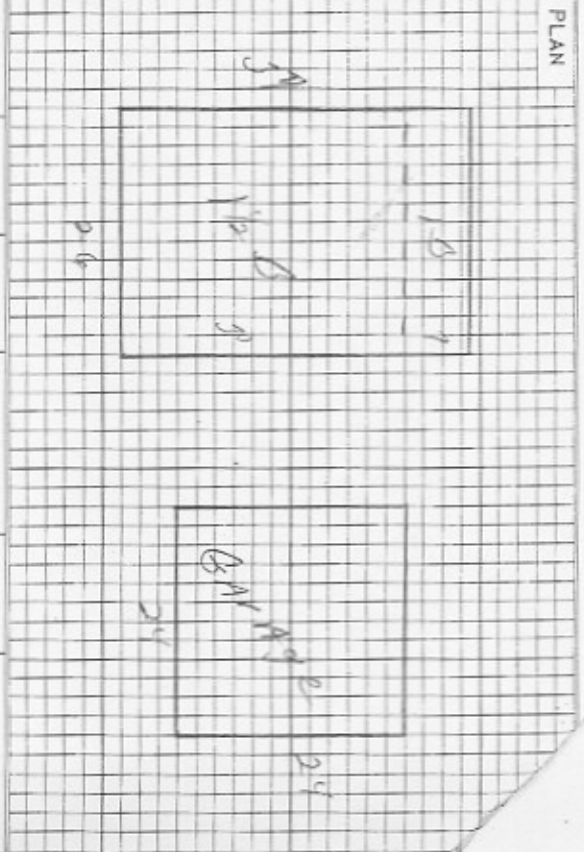

ITEM OR NO.	SQUARE FEET	UNIT COST	BASE VALUE	DEPR. & OBSOL. % GOOD	DEPR. VALUE
1A	280	\$18.78	\$5199		
1B	182	\$13.81	\$2519		
11			680		
16			2214		
17			99		
			20160	65%	13104

Total Dep. Value \$ _____
 Econ. Cond. Factor x _____ %
 True Cash Value \$ _____

20x4.95 = 99.00
 Hour
 26x1 = 26
 26x1 = 26
 962

576 = 2214
 576 = 2214
 20x4.95 = 99.00
 Hour
 26x1 = 26
 26x1 = 26
 962